

A1

Gross Area / 39.23m²
 建築面積

Net Area / 29.42m²
 實用面積

The Heart of It All
 我即中心

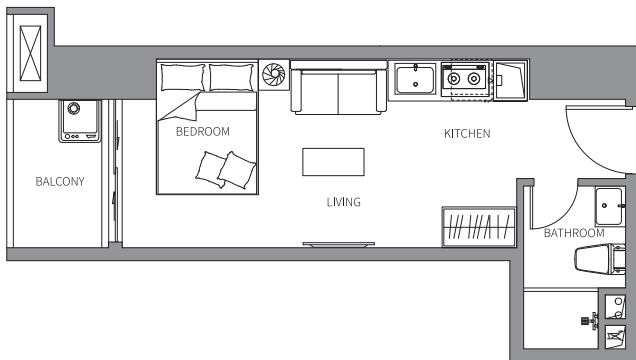

Floors:	7-14F 16-25F 26-31F 33-40F 41F
Gross Area:	39.23 m ²
Net Area:	29.42 m ²
Bedroom:	1
Bathroom:	1

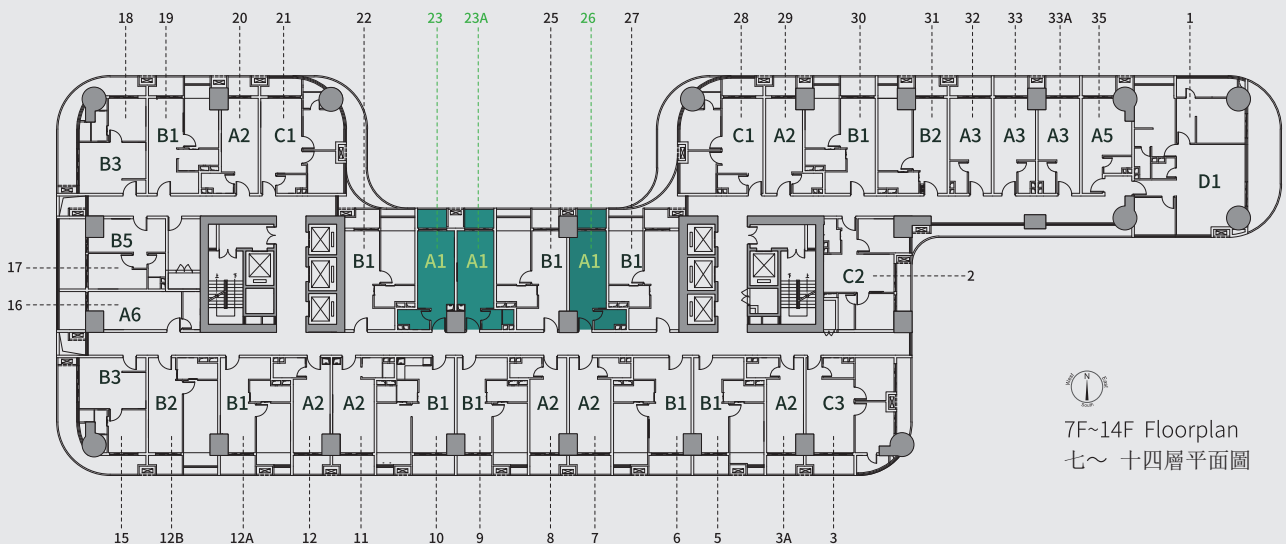

7F~14F Floorplan
 七~十四層平面圖